



OPTION 1
D.C. Major League Baseball Park

SHEET A1

ZONING COMMISSION
District of Columbia
CASE NO. 06-22A
EXHIBIT NO. 8A



Apr 10, 2008 02:48pm nriplot
\\group\files\WDC_0514017\05-14017-10\K-Cad\DC Nationals\Sheets\ARCH\~PS_A1-01 SERVICE - 100 LEVEL REFERENCE PLAN_842.dwg

AS-BUILT DRAWING SHOWING LOCATION OF EXISTING RETAIL SPACE ALONG FIRST STREET, SE.

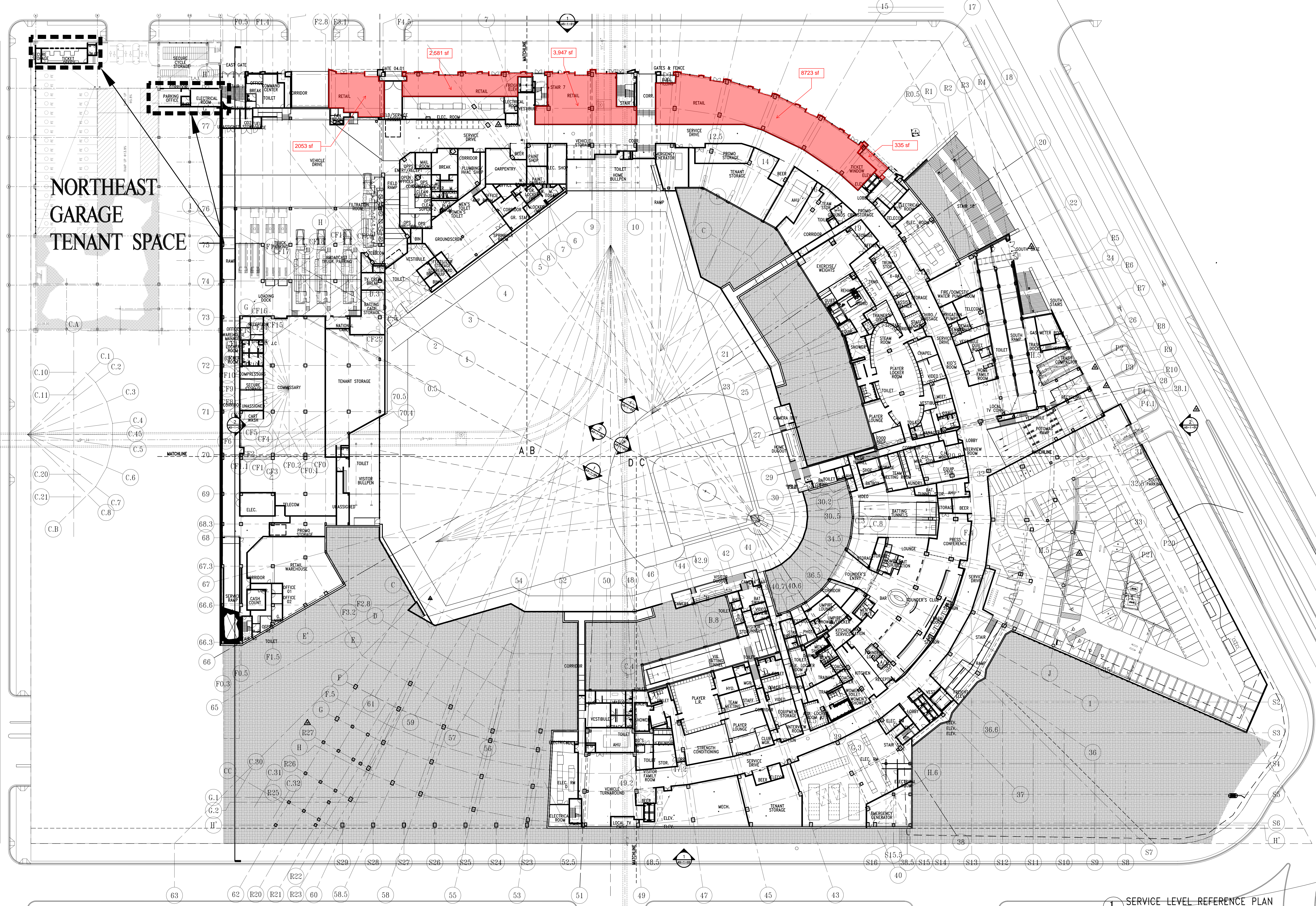

**NORTHEAST
GARAGE
TENANT SPACE**

2053 sf

2,581 sf

3,947 sf

8723 sf

335 sf

31

SERVICE LEVEL REFERENCE PLAN

1/32"=1'-0"



SPORT
HOK/DEVROUX & PURNELL, PLLC

HOK/D&P
Architecture, Engineering,
Planning, Interiors, Facility
Programming
3223 Grace Street NW
Washington, DC 20007

BOWIE GRIDLEY ARCHITECTS
INTERIOR ARCHITECTURE

DELOM HAMPTON
CIVIL ENGINEER

RESTI/THORNTON-TOMASETTI
STRUCTURAL ENGINEER

ME ENGINEERS/JVP/SIM-G
MECH/ELEC/PLUMB ENGINEER

WJHW/POLYSONICS
AUDIO/VISUAL CONSULTANT

S3 CONSULTANTS/PORTER
FOOD SERVICE CONSULTANT

PETER LIU ASSOCIATES, INC.
LANDSCAPE ARCHITECTURE

CATT LYON DESIGN
SIGNAGE & GRAPHICS

CLARK HUNT SMOOT
CONSTRUCTION MANAGER



**DC MAJOR LEAGUE
BASEBALL PARK**
WASHINGTON, DC

RECORD DRAWING SET
APRIL 11, 2008

PACKAGE

NO.	DATE	DESCRIPTION
14	09/08/06	DR#11
31	12/15/06	DR#14
35	01/26/07	ADDENDUM # 14.01
42	02/23/07	ADDENDUM # 14.03

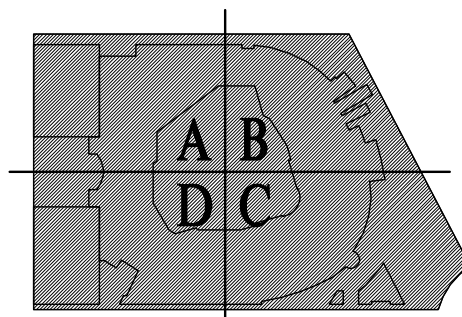

KEYPLAN
PROJECT NO. OS-14017-00
ISSUED BY: HOK/JP
DRAWN BY: REVIEWED BY:
ISSUE DATE: 28 AUGUST 2006
SHEET TITLE:

**SERVICE - 100 LEVEL
REFERENCE PLAN**

DISCIPLINE - CATEGORY - SUB-CATEGORY - SHEET
A1-01

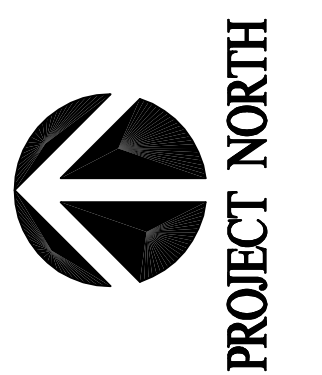

AS-BUILT DRAWING SHOWING COMPARISON OF APPROVED VERSUS EXISTING RETAIL SPACE ALONG FIRST STREET, SE.

Apr 10, 2008 02:46pm nripic

\\group\files\WDC_0514017\05-14017-10\K-Cad\DC Nationals\Sheets\ARCH\~PS_A1-01 SERVICE - 100 LEVEL REFERENCE PLAN_842.dwg

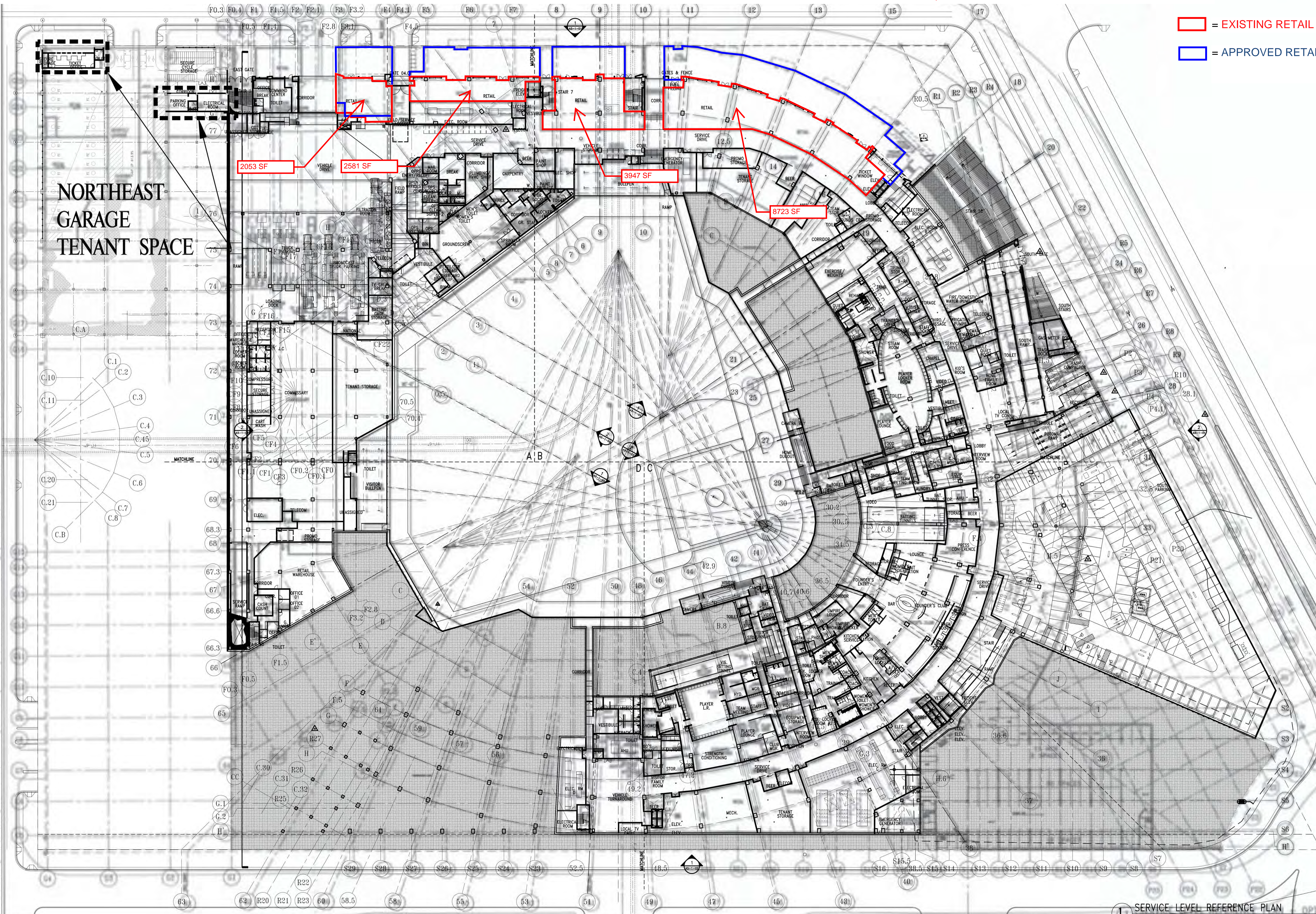

= EXISTING RETAIL SPACE
 = APPROVED RETAIL SPACE

**NORTHEAST
GARAGE
TENANT SPACE**

2053 SF

2581 SF

3947 SF

8723 SF

31

HOK
 SPORT
 HOK/DEVROUX & FURNELL, PLLC
 HOK/D&P
 Architecture, Engineering,
 Planning, Interiors, Facility
 Programming
 3223 Grace Street NW
 Washington, DC 20007
 BOWIE GRIFFIN ARCHITECTS
 INTERIOR ARCHITECTURE
 DELON HAMPTON
 CIVIL ENGINEER
 RESTI/THORNTON-TOMASETTI
 STRUCTURAL ENGINEER
 WE ENGINEERS/IMP/SIM-G
 MECH/ELEC/PLUMB ENGINEER
 J.W.H.W./POLYSONICS
 AUDIO/VISUAL CONSULTANT
 S3 CONSULTANTS/PORTER
 FOOD SERVICE CONSULTANT
 PETER LIU ASSOCIATES, INC.
 LANDSCAPE ARCHITECTURE
 GATT LYON DESIGN
 SIGNAGE & GRAPHICS
 CLARK HUNT SMOOT
 CONSTRUCTION MANAGER



**D.C. MAJOR LEAGUE
BASEBALL PARK**
 WASHINGTON, D.C.

RECORD DRAWING SET
 APRIL 11, 2008

NO.	DATE	DESCRIPTION
14	09/08/06	DR#11
31	12/15/06	DR#14
35	01/26/07	ADDENDUM # 14.01
42	02/23/07	ADDENDUM # 14.03

PACKAGE

NO.	DATE	DESCRIPTION
14	09/08/06	DR#11
31	12/15/06	DR#14
35	01/26/07	ADDENDUM # 14.01
42	02/23/07	ADDENDUM # 14.03

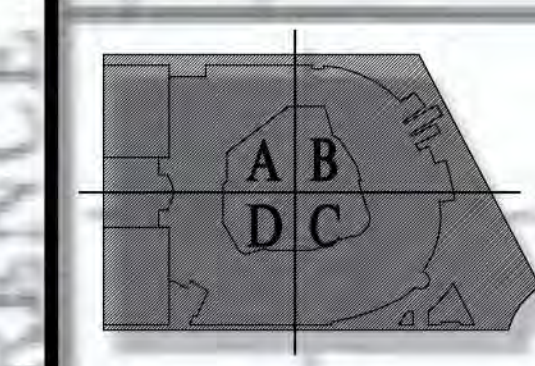

KEYPLAN

PROJECT NO.	ISSUED BY:
05-14017-00	HOK/DF
DRAWN BY:	REVIEWED BY:

ISSUE DATE:
 08 AUGUST 2008
 SHEET TITLE:

**SERVICE - 100 LEVEL
REFERENCE PLAN**

PROJECT - GARAGE - SUB-CADDDRY - SHEET

A1-01

FOR REFERENCE ONLY - NOT FOR CONSTRUCTION



1/32"=1'-0"
 SERVICE LEVEL REFERENCE PLAN